

# PRAGNA infra

*A name you can trust.*

## *2 BHK Luxury Apartments @ Isnapur*

Suryavamsi Township, 2.5 kms from ORR Exit 3

### HEALTH

MAHESHWARAM MEDICAL COLLEGE  
 10 Min Drive

### EDUCATION

CANDIDUS INTL SCHOOL 10 Min Drive  
 GITAM UNIVERSITY 10 Min Drive  
 THE GAUDIUM INTL SCHOOL 10 Min Drive  
 IIT HYDERABAD 10 Min Drive  
 SRI HAYATRI JUNIOR COLLEGE  
 OPEN MINDS INTL SCHOOL

### WORK

TOSHIBA, MICROSOFT  
 ISB, POLARIS  
 WIPRO, INFOSYS

### CONNECTIVITY

150 FT ROAD THROUGH THE SITE IS CONNECTING TO  
 ORR KARDANUR  
 ISNAPUR X ROADS 5 Min Drive  
 SANGAREDDY 15 Min Drive  
 BHEL, LINGAMPALLY 20 Min Drive  
 SHANKARPALLI 20 Min Drive  
 HITECH CITY 25 Min Drive  
 FINANCIAL DIST 30 Min Drive  
 RGIA INTL AIRPORT 40 Min Drive

### Site Address

Plot No. 63 & 64, 538 & 539  
 Suryavamsi Township  
 Isnapur, Patancheru

### Office Address

Plot No. 383, Suryavamsi Township  
 Isnapur, Patancheru (M), Sangareddy (D)  
 Ph: 98499 81867, 95507 44777, 94947 11567

# MNR HEIGHTS

File No. 054540/SKP/R1/U6/HMDA/12052022



Plot No. 63 & 64 - 1105 sft & 1135 sft

# PRAGNA SERENE

File No. 054541/SKP/R1/U6/HMDA/12052022



Plot No. 538 & 539 - 1105 sft & 1135 sft

## TYPICAL FLOOR PLAN

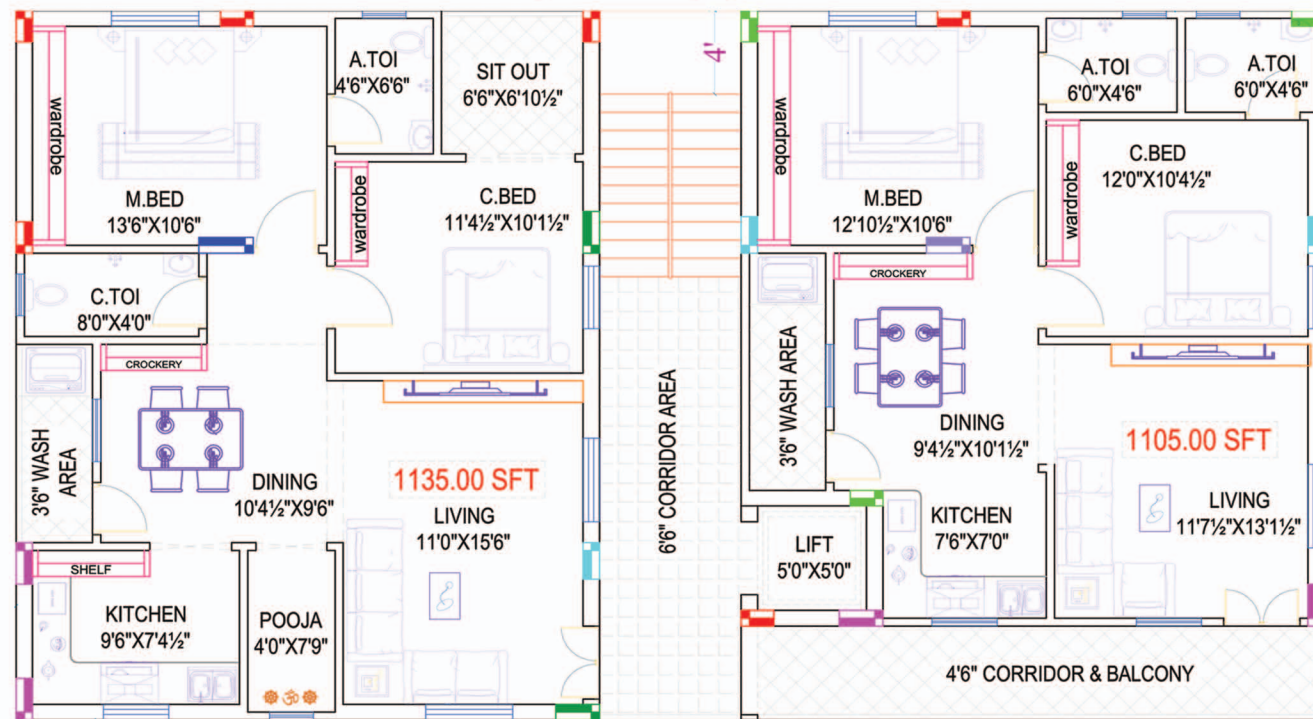

**TOTAL PLOT AREA : 334.57 Sq.Mts / 400.00 Sq.Yds.**

**EACH FLOOR AREA: 2240 SFT TOTAL 5 FLOORS AREA : 11200 SFT  
( WITH T D R FLOOR ) WITH 10% DEVIATION 25% COMMON AREA**



## SPECIFICATIONS

### STRUCTURE

R.C.C Framed Structure, Robo Sand/River Sand, Columns, Footings, Plinth, Beams with R.C.C. as per engineer's design (i.e. Suguna/ Shree TMT or equivalent) RMC or manual

### SUPER STRUCTURE

**BRICK WALLS** : All construction done by Red Brick

### DOORS

**MAIN DOORS** : Best Teak Wood door along with medium teak wood frame with Good quality hardware hinges, powder quoted

**INTERNAL DOORS** : Flsuh Door with Medium Teak Wood frame/WPC Doors with WPC frames along with good quality hardware hinges with powder quoted

**WINDOWS** : UPVC Windows with grill

### PAINTINGS/WALL FINISHINGS

**PAINT BRAND** : Asian Paints or Equivalent

### FLOORING

**DRAWING, DINING & LIVING & KITCHEN** : Anti skid Vitrified Tiles (Reputed make)

**BATH ROOMS** : Glazed Ceramic Tiles upto 6 feet. Anti skid glazed ceramic tile for flooring

**OUTSIDE PARKING AREA STAIRCASE & COMMON CORRIDOR** : Parking Tiles, Granite Flooring Tiles (Reputed make)

### TILES CLADDING & DADOING

**KITCHEN** : Kitchen platform is provided RCC with Granite platform with S/S sink and dadoing upto 2ft Height with tiles

**TOILETS** : Anti skid Ceramic Tile for flooring in Toilets and dadoing upto 6ft Height and Provision for geyser point in M.Bedroom Toilet

**SANITARY WARE (Fittings & Accessories)** : All taps, short and long body sanitary fittings with standard models of CERA/ HINDWARE or Equivalent.

### ELECTRICAL

**Electric Wiring** : Finecab/ Finolex or Equivalent

**Switches** : GM/Maaru or Equivalent

**Telecom & AC** : Cable TV, Provision for cable connection in living room, provision for AC point in all bedrooms

**LIFTS** : 6 Passengers manual door lift

**GENERATOR** : D.G. set back up for Common area and lift (combined blocks)

2 Lights & 2 Fans for every Flat

**WATER SUPPLY** : Undergorund and overhead storage tank for Borewater of suitable capacity with I.S.I pump  
.Underground municipal water storage tank and overhead storage tank with I.S.I pump.

### GROUND

**DRAINAGE LINE** : 8" Matti pipes